

TRACS Apr 14 UKI, Apr 15-16 2023 USDAA, Woodland CA

Check-in Schedule (check in only on your first day)

Check in/measure-in:	7:15 - 7:45AM
First walk through:	7:45AM
First dog on the line:	8:00AM

You must measure in if you don't have a height certification listed for you in your competitor services dashboard on the USDAA website.

Thank you for entering our Springtime USDAA/UKI Agility trial! This is a NICE sized UKI trial and a modest USDAA trial, which means we will be finished in plenty of time for afternoon tea! Please check the trial information that will be posted to the website, and your emailed entry confirmation; I *love* finding mistakes before the weekend. If you have anything to change, mail Karey Krauter at kek@bumpsays.com or call 650-906-5146.

Important Note to exhibitors: We must clean-up and bag all poop (it is in the contract - we will be fined if this is not done). Also do not allow dogs to urinate on trash cans or ANY structure!!!

AGILITY GATE: Yes! The access code is the trial date 0415.

FOOD: There will be no food available for purchase or otherwise on-site. Please bring your own!

WATER: We'll have water for all in 5-gal spigotted jugs: BRING YOUR OWN BOTTLE TO FILL! Be green!

WORKERS: Whiteboards will be ringside at each ring where everyone else can sign up on day-of, for which we will be deeply in your debt. Every class you work in will earn you tickets for our awesome Workers Raffle. If your Crew Chief doesn't give you one, don't be shy—ask for it! And did we mention lunch for working two or more classes??

SCORING, QUESTIONS, POSTING - Please check your results as soon as possible so we may resolve any questions you may have before the judge forgets what your run was like! If you want to check your score while your jump height is still running, feel free to peek over our shoulders. While it's true the score table is busy, we are never too busy to help you.

GATE HOURS: 7AM-9PM

Note that the gate into the interior of the fairgrounds will be open ONLY during these hours. If you want in after hours, you'll have to CALL Sandy (916-501-8319) and she'll direct you to the back gate which she will walk over to and open for you. **More better would be if you took care to enter before 9pm!**

BITCHES IN SEASON

Are allowed at this event, provided they wear sanitary britches the entire time they are in populated areas (pottying, around the rings, in the rings while running).

DIRECTIONS:

East on Interstate 80: Interstate 80 East to Woodland off ramp (Hwy.113). Take Gibson Rd. turn off. Turn left onto Gibson Rd. At Matmor signal turn right. Go to Gum Ave. (stop sign). Turn left onto Gum Avenue and, proceed west to main entrance of fair.

South on Interstate 5: Interstate 5 take Hwy. 113 (Main Street). Stay on 113 and take Gibson Road turn off. Turn right at Matmor signal and go to Gum Ave. Turn left onto Gum and proceed west to the main entrance.

North on Interstate 5: Take Interstate 5 North and take the E. Main Hwy 113 off ramp, turn left and follow E. Main street thru town. Turn left on East Street. Go to Gum Ave. and turn left. Go through the front entrance of the fairgrounds.

THURSDAY SETUP TIMELINE

NOON - RV's may arrive

NOON - Ring set-up starts. Competitors are very welcome to come then and help set up AND get preferential crating.

2PM - General competitor set up. If you show up before 2PM and are NOT helping with set-up at that time, then you will be invited to please wait until 2PM.

500PM - PRACTICE RUNS, AND SNACKS! \$10/run, \$25/three runs, each run is 60secs of whatever you need in the ring, except no food. **Retired agility dogs running with bars on the ground are FREE.** Our sainted co-chairs Sandy and Roe will be bringing snacks to enjoy while we play, feel free to bring some to share too!

Be aware that the fairground gates will be LOCKED after 9PM each day, and the competitor assumes all risk of leaving items overnight. TRACS will not be responsible for any loss or damage to items at the show site. See below GATE HOURS section on what to do after 9PM.

DAY PARKING - Parking is allowed in the interior of the fairgrounds, by the barns south of the starters/advanced ring. You will be directed AWAY from designated RV spots: please be considerate! Further, anyone parked inside may NOT MOVE THEIR VEHICLE while the trial is running (approximately between the hours of 7:30 a.m. and 4:00 p.m.). If you anticipate needing to move your vehicle during these hours, you should instead park in the main parking lot outside the fairgrounds front gate.

RV PARKING - Is by advance arrangement only, contact kek@bumpsays.com.

When you arrive, check in with Sandy Zajkowski for the permit you are required to display on your dashboard. RV spots are first-come-first-served, with the exception of some marked spots that will be reserved for key workers. If you want to RV with your friends, make your own arrangements to have the first arrived in your group save adjacent spots for the rest of your crowd.

JUDGE CHANGE - We are sad that Peggy has to step down from judging our show, and we are glad to tell you that Ken Boyd has offered to fill in for her.

FRIDAY UKI				SATURDAY USDA		SUNDAY USDA	
KEN-RING 1		GRUBEL/MCKENZIE-RING 2		KEN-MAS	GREMS-ST/ADV	GREMS-MAS	KEN-ST/ADV
tall-to-small		small-to-tall		CH-PF, tall-small	CH-PF, tall-small	PF-CH, small-tall	PF-CH, small-tall
Beg-Nov	Speedstks 1	Sen-Ch	Agility 2	(bye)	Combo Prs Rd 1	(bye)	Steeplechase
Sen-Ch	Speedstks 1	Beg-Nov	Agility 2	(bye)	Combo Prs Rd 2	Masters Gamblers	Adv-St Standard
Beg-Nov	Jumping 1	Sen-Ch	Snooker	Masters Jumpers	Adv-St Jumpers	Masters Standard	Adv-St Gamblers
Sen-Ch	Jumping 1	Beg-Nov	Snooker	BIATH Jumpers	Adv-St Snooker	Grand Prix	Adv-St Snooker
Beg-Nov	Gamblers	Masters	Jumping	Masters Snooker	Adv-St Gamblers	Masters Snooker	Adv-St Jumpers
Sen-Ch	Gamblers	Sen-Ch	Jumping 2	Masters Standard	Adv-St Standard	Masters Jumpers	
Beg-Nov	Agility 1	Beg-Nov	Jumping 2	Masters Gamblers	BIATH Standard		
Sen-Ch	Agility 1	Sen-Ch	Speedstks 2				
Masters	Agility	Beg-Nov	Speedstks 2				

DAY PARKING & RV LAYOUT

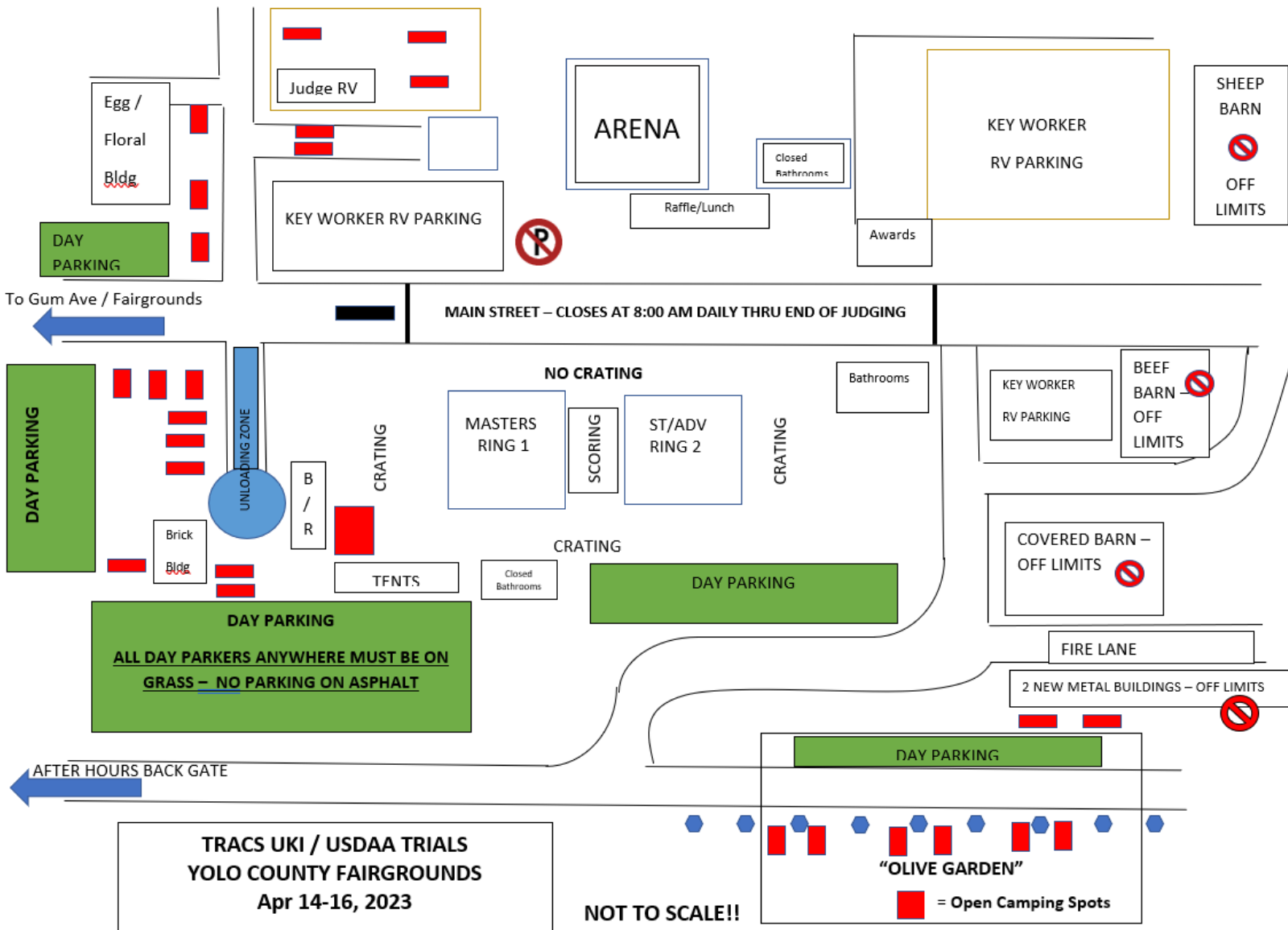

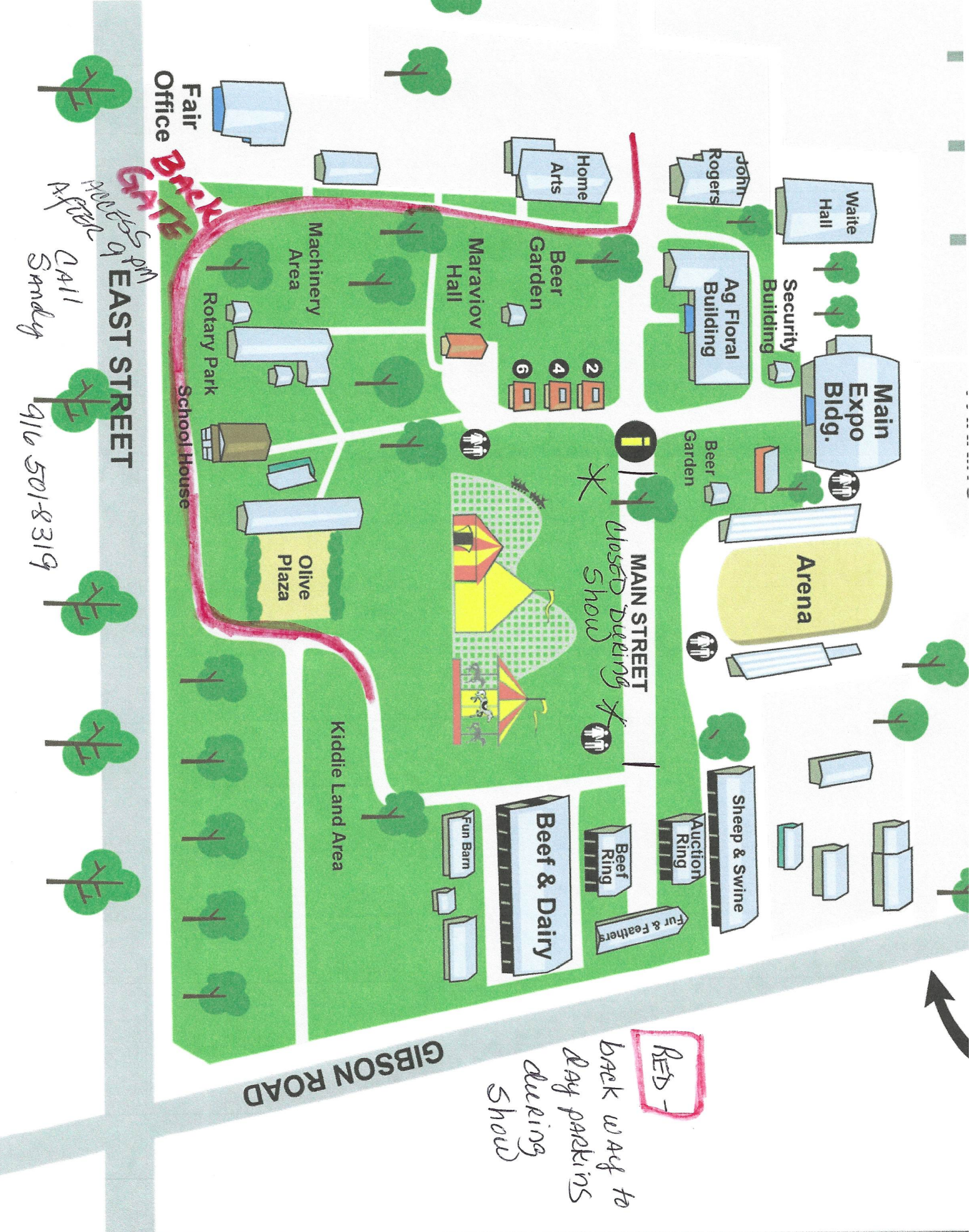

Fair Office

BACK GATE

EAST STREET

GIBSON ROAD

Main Expo Bldg.

Arena

Beef & Dairy

Machinery Area

Olive Plaza

Kiddle Land Area

MAIN STREET
CLOSED DURING SHOW

School House

ACCESS AFTER 5 PM

CALL SANDY

916 501-8319

RED -

back way to day parkings during show

