

**PREMIUM LIST**  
**TWO RIVERS AGILITY CLUB OF SACRAMENTO**  
**TRACKING DOG EXCELLENT TEST**  
AKC Licensed Event #2017584201

2017 TDX



**SUNDAY, JANUARY 29, 2017**

**MATHER REGIONAL PARK**  
**RANCHO CORDOVA, CALIFORNIA**

**ENTRIES LIMITED TO 3 DOGS**  
holding a tracking dog title  
**No mixed breed dogs allowed**

**ENTRIES CLOSE;**  
**Thursday, January 19, 2017**  
**AT 5:00 PM**  
**Entry fee: \$100.00**  
**(Includes \$0.50 AKC recording fee and \$3 event fee)**

**The draw to determine participants:**  
**Thursday, January 19, 2017 at 5:30 PM**  
**Jack in the Box Restaurant**  
**8655 Auburn Blvd., Roseville, CA**

**Entrants will be notified immediately by email, if provided**



**AMERICAN KENNEL CLUB CERTIFICATION**  
Permission has been granted by the American Kennel Club for the holding of  
this event under American Kennel Club Rules & Regulations  
James Crowley, Secretary

## Judges

Ms. Rita Crawford, (#90682), 903 Poplar Av, Sunnyvale CA 94086  
Ms. Kaye Hall, (#6018), 4516 Dry Creek Rd, Napa CA 94558

### Club Officers

President ..... Terry LeClair  
Vice-President...Karey Krauter  
Treasurer.....Jennifer Behrens  
Secretary ..... Katrina Parkinson  
160 Ralston Ave., Mill Valley, CA 04941

### Board Members

Sue Larson  
Cathy Beam  
Jim Aitken

Agility Coordinator: Sandy Zakowski      Tracking Coordinator: Rita Crawford

### Test Secretary

**Penny Larson**

2119 Beckenham Way, Roseville, CA 95747  
(415) 999-2631      plarson@ccsf.edu

### Chief Track Layer

Sue Larson

### Tracking Test Committee

Penny Larson– Chair, Sue Larson, Meg Azevedo, Cathy Beam, Susan McClair

**Closing Date:** Entries will be accepted until 5:00 PM on Thursday, January 19, 2017, after which time entries will not be accepted, canceled, altered or substituted.

**Entry Fee:** \$100.00. A \$0.50 recording fee and \$3.00 event service fee is included in each entry and will be forwarded to the AKC per CH 11, Sec. 2 of the AKC Rules and Regulations. Make checks payable to **TRACS**.

**Tracking Test Entries:** Dogs holding the title of Tracking Dog Excellent shall not be barred from competition; however, dogs not having a TDX will be given preference by the Test Secretary. Entries are limited to 3 dogs. No mixed breed dogs will be accepted for this test.

**The Draw:** A random drawing of all entries received by the closing time and date to determine which entries will participate in the test will take place on Thursday, January 19, 2017 at 5:30 PM, Jack in the Box, 8655 Auburn Blvd., Roseville, CA

**Alternate List:** An alternate list will be maintained and will consist of entries received by the closing date but not pulled in the initial draw. Drawing for the alternate list will immediately follow the drawing for entries which are to run.

**Notification:** Notification of the draw results will be made as soon as possible after entries have closed. Should such notification not be received by the exhibitor within a reasonable time, please contact the Test Secretary. Judging Program will be provided by email and USPS Mail.

**This club does not agree to arbitrate claims as set forth on the Official AKC entry form for this event.**

**Test Worker Option:** One (1) TDX track will be reserved for test workers who have earned required credit. If necessary, a random drawing may be held to determine which test worker is chosen. The remaining workers will automatically be included in the drawing with all other tracking entries received.

**Refund policy:** The entry fee shall be refunded to any entrant if the secretary is notified prior to the draw of such withdrawal and an alternate is available to run the track. All alternates not given the opportunity to run a track will receive a refund of their entry fees.

**Bitches in season may participate:** If you know that your bitch will be in season the day of the test, notify the test secretary ahead of time. When you arrive at the test site, park your vehicle away from the other cars and notify the test secretary that your entered bitch is in season. The last track to be laid will be reserved for the bitch in season. If there is more than one bitch in season, a second draw for those bitches will be held. Bitches in season will only be allowed to participate after all other dogs and bitches not in season have been tested. They must be kept away from the rest of the entered dogs. Failure to comply will result in the handler and dog being excused from the test site and any award withheld.

**Draw for running order:** All entrants must be at the test site by 9:45 AM the morning of the test, at which time there will be a draw for running order. Entrants not present at that time will be marked absent and an alternate will be allowed to run in their place.

**Judging will begin** as soon as tracks have sufficiently aged.

**Awards:** A dark green qualifying ribbon, a rosette, and a photograph will be awarded to each passing team.

**Dogs on leash:** All dogs and bitches entered in this test must be kept on leash at all times. Failure to comply will result in the dog and handler being excused from the test site. This also applies to any non-entered dogs that may accompany anyone at this test.

**Directions to test site:** From Sacramento take Hwy 50 towards Placerville. Take Zinfandel Dr. exit and go South approx 4 miles to Douglas Rd. Proceed straight across Douglas Rd. After crossing Douglas, continue 2/10 mile and turn left into Mather Field Rotary Park where we will meet for the draw.

**From Placerville** take Hwy 50 towards Sacramento. Exit on Sunrise Blvd. South. Proceed south 4 miles to Douglas Rd. Turn Right onto Douglas and proceed to traffic signal at Zinfandel Dr. (formerly Eagles Nest Rd.) Turn Left onto Zinfandel, go 2/10 of a mile and turn Left into Mather Field Rotary Park.

**Practicing is allowed in the fields.** Please respect the signs that indicate where dogs are allowed.

**Veterinarian on Call:** Sacramento Animal Medical Group. will be the on-call emergency veterinary hospital – 4990 Manzanita Avenue, Carmichael, CA 95608 (916) 331-7430

**OFFICIAL AMERICAN KENNEL CLUB ENTRY FORM**

**TWO RIVERS AGILITY CLUB OF SACRAMENTO**  
 AKC LICENSED TRACKING DOG EXCELLENT TEST #2013584201  
 SUNDAY, JANUARY 29, 2017  
 Mather Regional Park, Rancho Cordova, CA  
 Entry Fee: \$100.00 (includes \$.50 AKC recording fee and \$3.00 event fee)  
 Entries close: Thursday, January 19, 2017 at 5:00 PM. Entries limited to 3 AKC dogs.  
 Make checks payable to: Two Rivers Agility Club of Sacramento (TRACS)  
 Mail to: Penny Larson, Test Secretary, 2119 Beckenham Way, Roseville, CA 95747  
 Overnight & Express mail entries MUST specify NO SIGNATURE REQUIRED  
**NOTE: Agreement part must accompany this sheet—legible handwriting appreciated**

I ENCLOSE \$.....for entry fees

**IMPORTANT—Read Carefully Instructions on Reverse Side Before Filling Out. Numbers in the boxes indicate sections of the instructions relevant to the information needed in that box (PLEASE PRINT)**

BREED		VARIETY <sub>1</sub>	SEX	
DOG <sub>2</sub> SHOW CLASS		CLASS <sub>3</sub> DIVISION <small>Weight, color etc.</small>		
ADDITIONAL CLASSES	OBEDIENCE CLASS <b>TDX</b>	RALLY CLASS <small>(Jump Height)</small>	JR. SHOWMANSHIP CLASS	
NAME OF (See Back) JUNIOR HANDLER (in any)			JR. HANDLER NUMBER	
FULL NAME OF DOG				
<input type="checkbox"/> AKC REG NO. <input type="checkbox"/> AKC LITTER NO. <input type="checkbox"/> ILP NO. <input type="checkbox"/> FOREIGN REG NO & COUNTRY		Enter number here	DATE OF BIRTH	
			PLACE OF BIRTH <input type="checkbox"/> USA <input type="checkbox"/> Canada <input type="checkbox"/> Foreign	
BREEDER				
SIRE				
DAM				

ACTUAL OWNER(S) <small>4</small>	_____
OWNER'S ADDRESS	_____
CITY	STATE
	ZIP

**NAME OF OWNER'S AGENT (IF ANY) AT THE SHOW**  
 \_\_\_\_\_  
 I CERTIFY that I am the actual owner of the dog, or that I am the duly authorized agent of the actual owner whose name I have entered above. In consideration of the acceptance of this entry, I (we) agree to abide by the rules and regulations of The American Kennel Club in effect at the time of this event, and by any additional rules and regulations appearing in the premium list for this event, and further agree to be bound by the "Agreement" printed on the reverse side of this entry form. I (we) certify and represent that the dog entered is not a hazard to persons or other dogs. This entry is submitted for acceptance on the foregoing representation and Agreement. I (we) agree to conduct myself (ourselves) in accordance with all such Rules and Regulations (including all provisions apply to discipline) and to abide by the decisions made in accord with them.

\* SIGNATURE of owner or his agent  
 Duly authorized to make this entry \_\_\_\_\_

TELEPHONE# \_\_\_\_\_

E-MAIL Address (An acknowledgement or receipt of entry may be sent to this e-mail address): \_\_\_\_\_

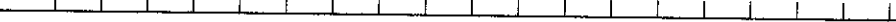

**AGREEMENT**

I (we) agree that the club holding this event has the right to refuse this entry for cause which the club shall deem sufficient. In consideration of the acceptance of this entry and of the holding of this event and of the opportunity to have the dog judged and to win prizes, ribbons, or trophies, I (we) agree to hold the AKC, the event-giving club, their members, directors, governors, officers, agents, superintendents or event secretary and the owner and/or lessor of the premises and any provider of services that are necessary to hold this event and any employees or volunteers of the aforementioned parties, and any AKC approved judge, judging at this event, harmless from any claim for loss or injury which may be alleged to have been caused directly or indirectly to any person or thing by the act of this dog while in or about the event premises or grounds or near any entrance thereto, and I (we) personally assume all responsibility and liability for any such claim; and I (we) further agree to hold the aforementioned parties harmless from any claim for loss, injury or damage to this dog.

Additionally, I (we) hereby assume the sole responsibility for and agree to indemnify, defend and save the aforementioned parties harmless from any and all loss and expense (including legal fees) by reason of the liability imposed by law upon any of the aforementioned parties for damage because of bodily injuries, including death at any time resulting therefrom, sustained by any person or persons, including myself (ourselves), or on account of damage to property, arising out of or in consequence of my (our) participation in this event, however such, injuries, death or property damage may be caused, and whether or not the same may have been caused or may be alleged to have been caused by the negligence of the aforementioned parties or any of their employees, agents, or any other persons. I (WE) AGREE THAT ANY CAUSE OF ACTION, CONTROVERSY OR CLAIM ARISING OUT OF OR RELATED TO THE ENTRY, EXHIBITION OR ATTENDANCE AT THE EVENT BETWEEN THE AKC AND THE EVENT-GIVING CLUB (UNLESS OTHERWISE STATED IN ITS PREMIUM LIST) AND MYSELF (OURSELVES) OR AS TO THE CONSTRUCTION, INTERPRETATION AND EFFECT OF THIS AGREEMENT SHALL BE SETTLED BY ARBITRATION PURSUANT TO THE APPLICABLE RULES OF THE AMERICAN ARBITRATION ASSOCIATION. HOWEVER, PRIOR TO ARBITRATION ALL APPLICABLE AKC BYLAWS, RULES, REGULATIONS AND PROCEDURES MUST FIRST BE FOLLOWED AS SET FORTH IN THE AKC CHARTER AND BYLAWS, RULES, REGULATIONS, PUBLISHED POLICIES AND GUIDELINES.

**INSTRUCTIONS**

(Variety) If you are entering a dog of a breed in which there are varieties for show purposes, please designate the particular variety you are entering, i.e. Cocker Spaniel (solid color black, ASCOB, parti-color), Beagles (not exceeding 13 in., over 13 in. but not exceeding 15 in.), Dachshunds (long-haired, smooth, wirehaired), Collies (rough, smooth), Bull Terriers (colored, white), Manchester Terriers (standard, toy), Chihuahua (smooth coat, long coat), English Toy Spaniels (King Charles and Ruby, Blenheim and Prince Charles), Poodles (toy, miniature, standard).

A dog must be entered in the name of the person who actually owned it at the time entries for a trial closed. If a registered dog has been acquired by a new owner, it must be entered in the name of its new owner in any trial for which entries closed after the date of acquirement, regardless of whether the new owner has received the registration certificate indicating that the dog is recorded in his/her name. State on entry form whether transfer application has been mailed to AKC. (For complete rules, refer to Chapter 11, Section 3.)

If this entry is for Junior Showmanship, please give the following information:

JUNIOR SHOWMANSHIP JR.'S DATE OF BIRTH \_\_\_\_\_

AKC JUNIOR HANDLER NUMBER

The above number MUST be included. Should you not have your Junior Handler number, this may be obtained from the American Kennel Club. Phone: (919) 816-3776.

By signing the entry form I (we) certify that the Junior Showman does not now, and will not at any time, act as an agent/handler for pay while continuing to compete in Junior Showmanship.

ADDRESS \_\_\_\_\_  
CITY \_\_\_\_\_ STATE \_\_\_\_\_ ZIP \_\_\_\_\_

If Junior Handler is not the owner of the dog identified on the face of this form, what is the relationship of the Junior Handler to the Owner?

**CATALOG**

**TWO RIVERS AGILITY CLUB OF SACRAMENTO  
TRACKING DOG EXCELLENT TEST  
AKC LICENSED EVENT #2017584201**

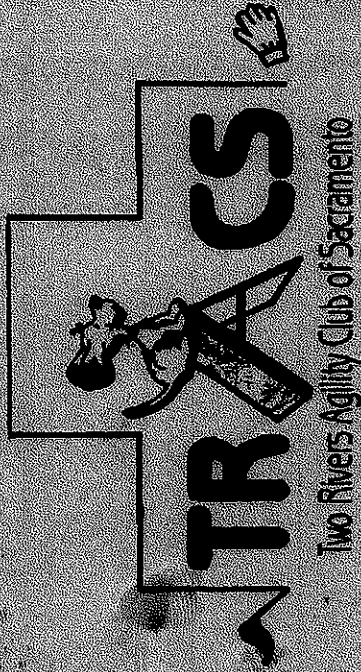

Mather Regional Park  
Rancho Cordova, CA  
Sunday, January 29, 2017

**DRAW FOR RUNNING ORDER WILL BE AT  
9:30 AM, January 29, 2017 AT THE TEST SITE**

Test hours: 6:00AM to 4:00PM  
Judging will begin when the tracks  
have sufficiently aged

**AMERICAN KENNEL CLUB CERTIFICATION**  
Permission has been granted by the American Kennel Club for the holding  
of this event under American Kennel Club rules & regulations.  
James P. Crowley, Secretary



## TRACKING DOG EXCELLENT TEST ENTRANTS

- X101. Hare-Raiser Straight Shooter TD, HP37525602, 4-16-10. Bdr: Jan Weiher and Don Neiffer, By FC Random Farms Jake II ex CH Hare-Raiser Spring Into Action. **Owner: Meg Azevedo, 8228 Woods Edge Lane, Elk Grove, CA 95758** (Beagle 15 inch, Dog)
- withdrawn\_X102. DD's Leaps 'N Bounds VCD2 TD UD BN RN AX AXJ. SR71992307, 2-28-12. Bdr: Dee Dee and Billy Anderson & Dimity Mueller. By CH Mirasol Nose No Blarney RA JH OA OAJ NF ex DD's Look Before U Leap VCD3 BN RE. **Owner: Dimity Mueller, 21781 Virdelle Dr., Los Gatos, CA 95033.** (Golden Retriever, Bitch)
- X103. CH Aukai's Stairway to Heaven CGC RN TD BN, WS48031201, 8-31-14. Bdr: Cherrie A. Brown and Patti Emmerling. By GCH CH Tempest's Ramble On To Aukai CDX, RE, TD ex CH 911 Aukai I Malama Ahi CD, RA, TD. **Owner: Dr. Cherrie A. Brown, 7816 Setter Ln, Vacaville, CA 95688.** (Newfoundland, Bitch)
- withdrawn\_X104. DD's Singin' in the Rain TD RE BN PCD NA NAJ, SR78920506, 8-12-13. Bdr: Dee Dee and Billy Anderson. By Saga T's Magnitude 3.0 ex DD's Slice of Pie. **Owner: Susan Dickerson 1142 Bridgetowne Drive, Lodi, CA 95242** (Golden Retriever, Bitch)
- X105. Ridgerunner Curious Canine RN TD, TDU, HP43667304, 7-8-12. Bdr: Tracy and Keith Favre. By CH Heathcliff Claimjumper ex CH Ridgerunner Brazos Bluebonnet, **Owner: Michael McMillan, 949 Juanita Court, El Sobrante, CA 94803** (Bloodhound, Bitch)
- X106. CH Wynfield Meriadoc The Helmsman TD CAA BN RN, HP43845401, 7-20-12. Bdr: Ellen Parr, Doug Flatbush & Lori Bulmer. By GCH Bougain'e Naughty-N-Lovely Alvin ex CH Wynfield Music By Meriadoc TD. **Owner: Ellen Parr, Doug Flatbush & Lori Bulmer, 8875 Red Tail Lane, Nampa, ID 83686** (Beagle, 15 inch, Dog)
- X107. GCH Fog Horn Apollo BN RN TD CGC, WS33405201, 1-12-10. Bdr: Judy and Torin Knorr. By CH Poach Cove's Orion Leal RA ex CH Cortereal Electra VCD1 BN TD AX AXJ NAP NJP NFP. **Owner: Judy & Torin Knorr, 1120 Palm Ave., San Mateo, CA 94401** (Portuguese Water Dog, Dog)
- X108. Pinehaven Zachariah Windsong TD, WS44368703, 5-20-13. Bdr: Beverly Dee Rafferty and Victoria Robinson. By Pinehaven Braveheart ex CH Pinehaven Manitou's Believe In Magic, **Owner: Emmy Verkozen 6815 Hutchins Ave., Sebastopol, CA 95472-4562** (Portuguese Water Dog, Dog)
- X109. Autumnwind Celebrates TGIF With Neptune TD RN, SR84963007. 10/24/14. Bdr. Linda L. Isaacson & Michael Issacson & Marjorie Blake. By GCH CH Harborview Under Construction ex Quailwood Only In My Dreams, **Owner: Pam Kennedy, 6298 N. Butaan, Clovis, CA 93619.** Agent: Billy Anderson. (Golden Retriever, Bitch)
- X110. Lorac's Trail Blazer HT PT HSAs CGC RN TD, DN35826801, 1/9/13. Bdr: Carol Harvey, By Western Hills Got My Mind Set on U ex Lorac Jonquil Ginger Lossuenos, **Owner: Lora Cox, 1467 Pashote Ct., Milpitas, CA 95035** (Australian Shepherd, Dog)
- X111. DD's Leap Into My Heart TD CD RN, SR71992304, 2-28-12. Bdr: Dee Dee & Billy Anderson & Dimity Mueller. By CH Mirasol's Nose No Blarney ex DD's Look Before U Leap. **Owner: Shelly Johnson, 3055 Greentree Way, San Jose, CA 95128-4014** (Golden Retriever, Bitch)
- X112. MACH FC Northstar's Let Freedom Ring SC CDX TD MXS MJS, HP37985601, 7-2-10. Bdr: Carol & Jerry Vesely. By GCH Paradigm's Aariel's Undisputed ex DC Freedom's Pride of Northstar MC CDX RE AX AXJ, **Owner: Carol & Jerry Vesely, 2475 Huston Ct., Morgan Hill, CA 95037** (Rhodesian Ridgeback, Dog)

2017 TD X

## Judges

withdrawn\_X113. DD's Serengeti Surfin' Safari VCD2 BN  
GN RE MX MXJ MJB XF THD CGC, SR58605502, 9-13-09. Bdr:  
Dee Dee Anderson, Billy Anderson, Deborah Best. By Hyegold  
Midsumr Knights Dream CDX RAE TDX JH ex CT-OTCH  
Northwood Merry Moonsprite UDX11, OGM VER, PUTD, RAE,  
TDX, VST, TDU. **Owner: Michelle Pressel, 3354 Mission  
Drive, Santa Cruz, CA 95065** (Golden Retriever, Bitch)

withdrawn\_X114. Blue Diesel TD DJ, DN36047001, 2-17-  
13. Bdr: Rebecca Rodgers. By Diego Armando Von Der  
Roggenstrasse ex Prada Vom Valkyre. **Owner: Colleen &  
Dustin Bartley, P.O. Box 716, Clements, CA 95227** (German  
Shepherd Dog, Dog)

X115. Hob Nob Buried Treasure TD, AX, AXJ,  
MXF, DN21274105, 5-2-08. Bdr: Janice DeMello. By Hob Nob  
Set in Stone, ex Hob Nob High Class. **Owner: Karey Krauter,  
374 Stanford Ave., Palo Alto, CA 94306** (Border Collie, Bitch)

## AWARDS

Each dog passing will be awarded a photograph,  
a green qualifying ribbon and a rosette.

Mrs Kaye Hall, (#6018) 4516 Dry Creek Rd, Napa, CA 94558  
Ms. Rita Crawford, (#90682) 903 Poplar Ave. Sunnyvale, CA 94086

## Club Officers

President Terry LeClair  
Vice-President Susan Cochran  
Treasurer Sandy Zajkowski  
Secretary Becky Hardenbergh  
8027 Grinzing Way,  
Elk Grove, CA 95829  
Tracking Coordinator Rita Crawford  
Agility Coordinator Kathie Leggett

## Board Members

Jim Aitken  
Vickey Meyer  
Katrina Parkinson

## Tracking Test Secretary and Chairperson

Penny Larson

2119 Beckenham Way, Roseville, CA 95747  
415-999-2631, e-mail: [plarson@ccsf.edu](mailto:plarson@ccsf.edu)

## Test Committee

Penny Larson - Chair, Cathy Beam, Sue Larson, Susan McClair, Pam Flanagan

## Chief Tracklayer

Sue Larson

## Driver

Stephanie Laston

## Photographer

Sue Larson

## Tracklayers

Sue Bailey, Cathy Beam, Margot McKereghan, Colton Meyer,  
Susan McClair, Pam Flanagan, Bob Dant, Sandy Zajkowski

**Veterinarian on Call:** Sacramento Veterinary Surgical Services Inc. will  
be the on -call emergency veterinary hospital - 9801 Old Winery Place,  
Rancho Cordova, CA. 95827 (916) 362-3111

**In Case of Human Emergency:** Call 9-1-1

I hereby certify to the correctness of the within marked awards and absentees from  
the judges' books.

\_\_\_\_\_  
Penny Larson, Test Secretary



Sue B

DOG'S CATALOG # X101

TRACK # 1

TOTAL YDS 815

VEG. TOX

Chart the track in solid line; the dog's course in broken line on graph below.

NON-VEG.     

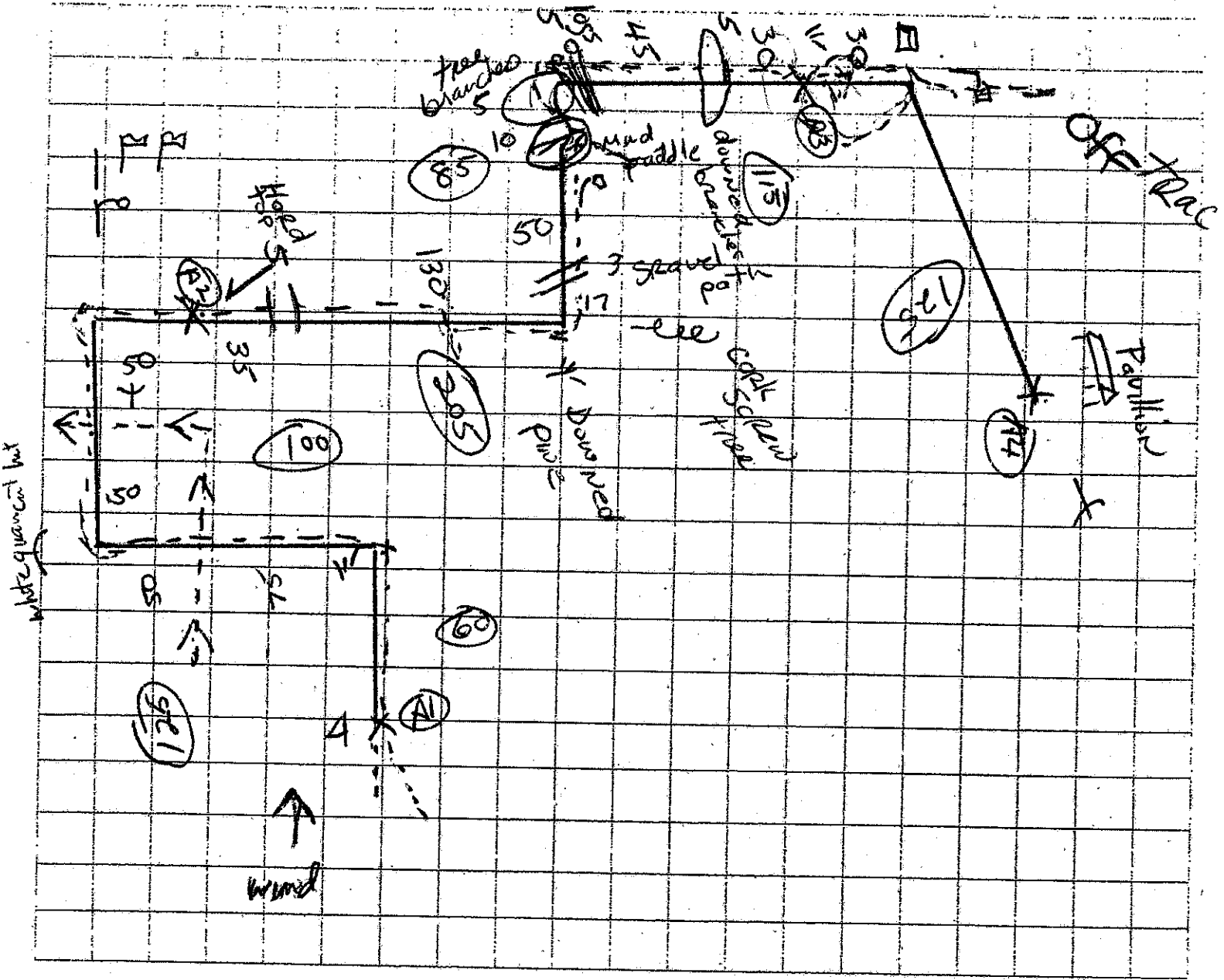

Passed or Failed OFF track  
 (If failed state reason)  
 Tracklayer Started 7A  
 X-Tracklayer Started 8:30 A  
 Dog's Starting Time 10:03  
 Dog's Finishing Time \_\_\_\_\_  
 Ground Conditions wet field grass  
 Weather Conditions Summer Cool  
 Wind Speed slight

Articles: 1. Scarf 2. Memory book  
3. sock 1. glove  
 Obstacles/  
 Surfaces: 1. gravel 2. mud puddle  
3. branches 1. logs 5. Hoop  
6. gravel path top  
 Breed/Sex Beagle/Male  
 AKC Regis # #P 37525602  
 Event # 2017 84201 / TRACS

If dog is absent, mark "absent" on the page.

I hereby certify that I have judged the above dog after having read the instructions on the cover of this book and followed them to the best of my ability.

RL Crawford  
Judge's Signature

DOG'S CATALOG # V101

TRACK # 1

TOTAL YDS 815

VEG. TDX

Chart the track in solid line; the dog's course in broken line on graph below.

NON-VEG. \_\_\_\_\_

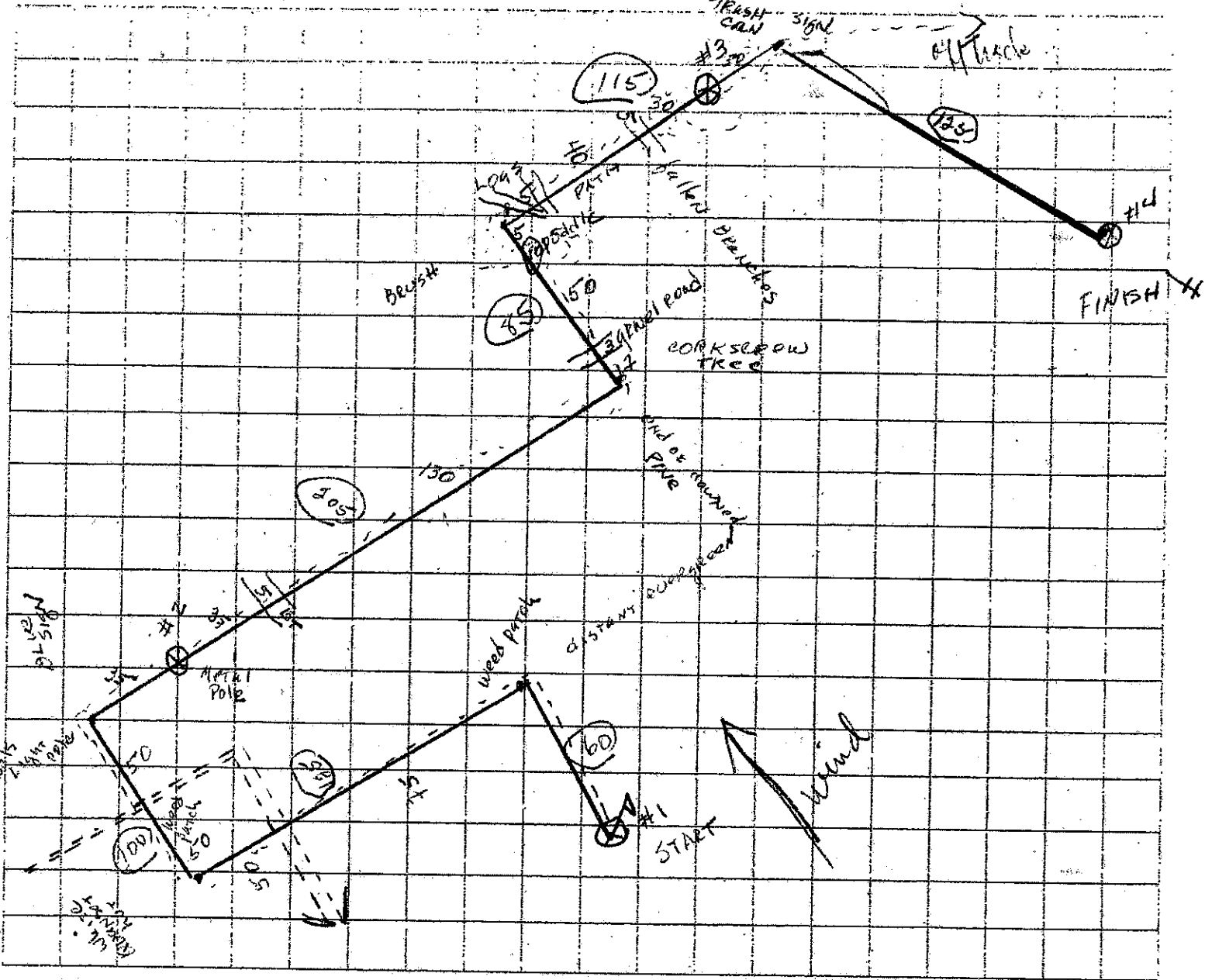

Passed or Failed Failed off track

(If failed state reason)

Tracklayer Started 7:00

X-Tracklayer Started 8:30

Dog's Starting Time 10:03

Dog's Finishing Time \_\_\_\_\_

Ground Conditions wet field grass

Weather Conditions sunny cool

Wind Speed slight

If dog is absent, mark "absent" on the page.

I hereby certify that I have judged the above dog after having read the instructions on the cover of this book and followed them to the best of my ability.

Articles:

- 1. scarf
- 2. memory book
- 3. sock
- 4. glove

Obstacles/  
Surfaces:

- 1. asphalt xing
- 2. puddle of water
- 3. log
- 4. fallen branches

Breed/Sex Beagle male

AKC Regis # HP 37525602

Event # TRACS 2017-584201

D. Campbell  
Judge's Signature

DOG'S CATALOG # ~~X103~~ <sup>103</sup>

TRACK # 2 <sup>TDX</sup>

TOTAL YDS 815

VEG. —

Chart the track in solid line; the dog's course in broken line on graph below.

NON-VEG. —

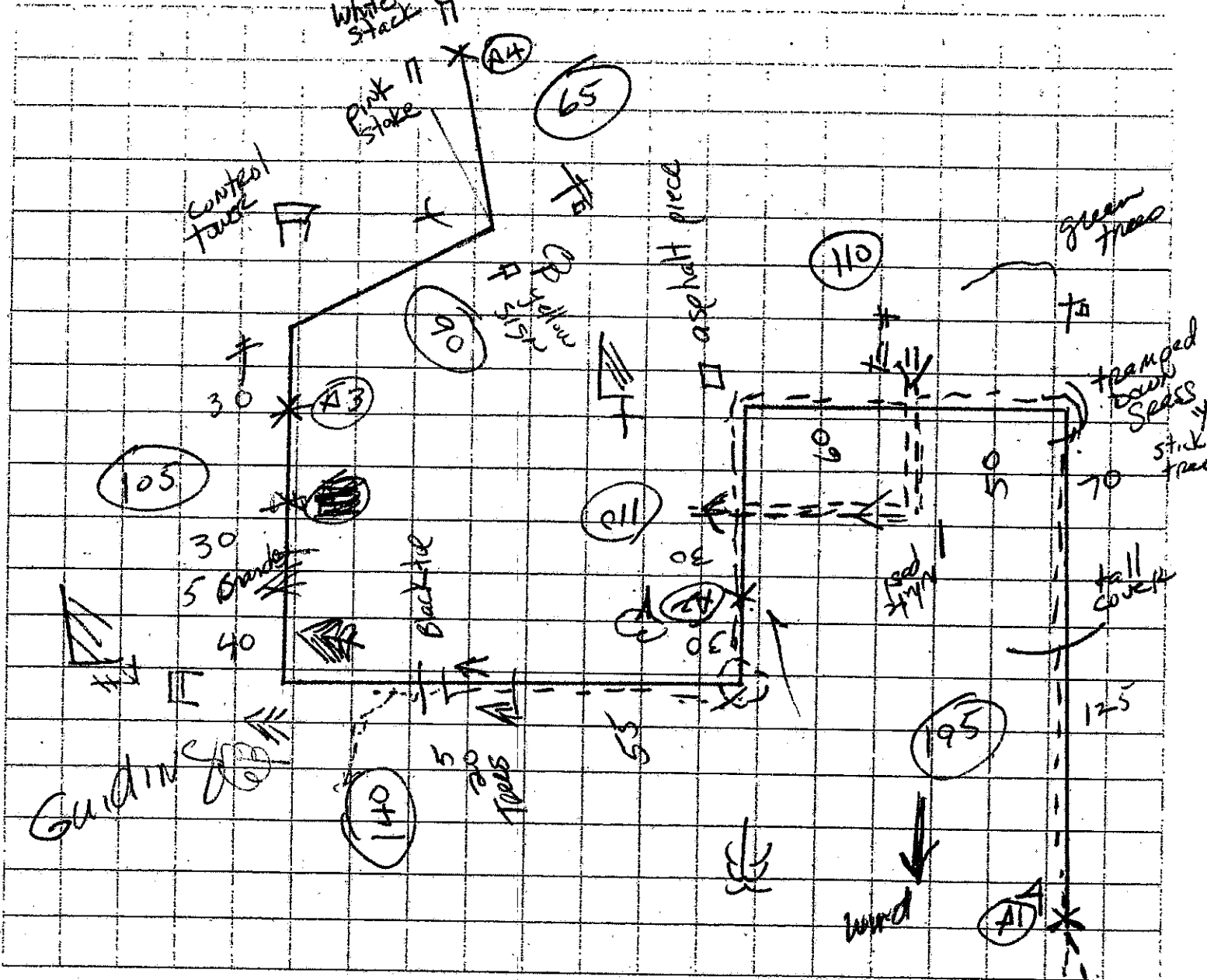

Passed or Failed Guiding  
 (If failed state Reason)  
 Tracklayer Started 7:30 A  
 X-Tracklayer Started 9 A  
 Dog's Starting Time 10:57 A  
 Dog's Finishing Time \_\_\_\_\_  
 Ground Conditions wet fields  
 Weather Conditions sunny/cool  
 Wind Speed slight breeze

If dog is absent, mark "absent" on the page.

Articles: 1 scarf 2 memory book  
3 coin purse 1 glove  
 Obstacles/Surfaces: 1 trees 2 Blacktop  
3 Beards  
 Breed/Sex Newfoundland / Female  
 AKC Regis # HP43667304  
 Event # 2017584201 / TRACS

I hereby certify that I have judged the above dog after having read the instructions on the cover of this book and followed them to the best of my ability.

RL Crawford  
Judge's Signature

DOG'S CATALOG # X102

TRACK # 2

TOTAL YDS 815

VEG. TDX

Chart the track in solid line; the dog's course in broken line on graph below.

NON-VEG. \_\_\_\_\_

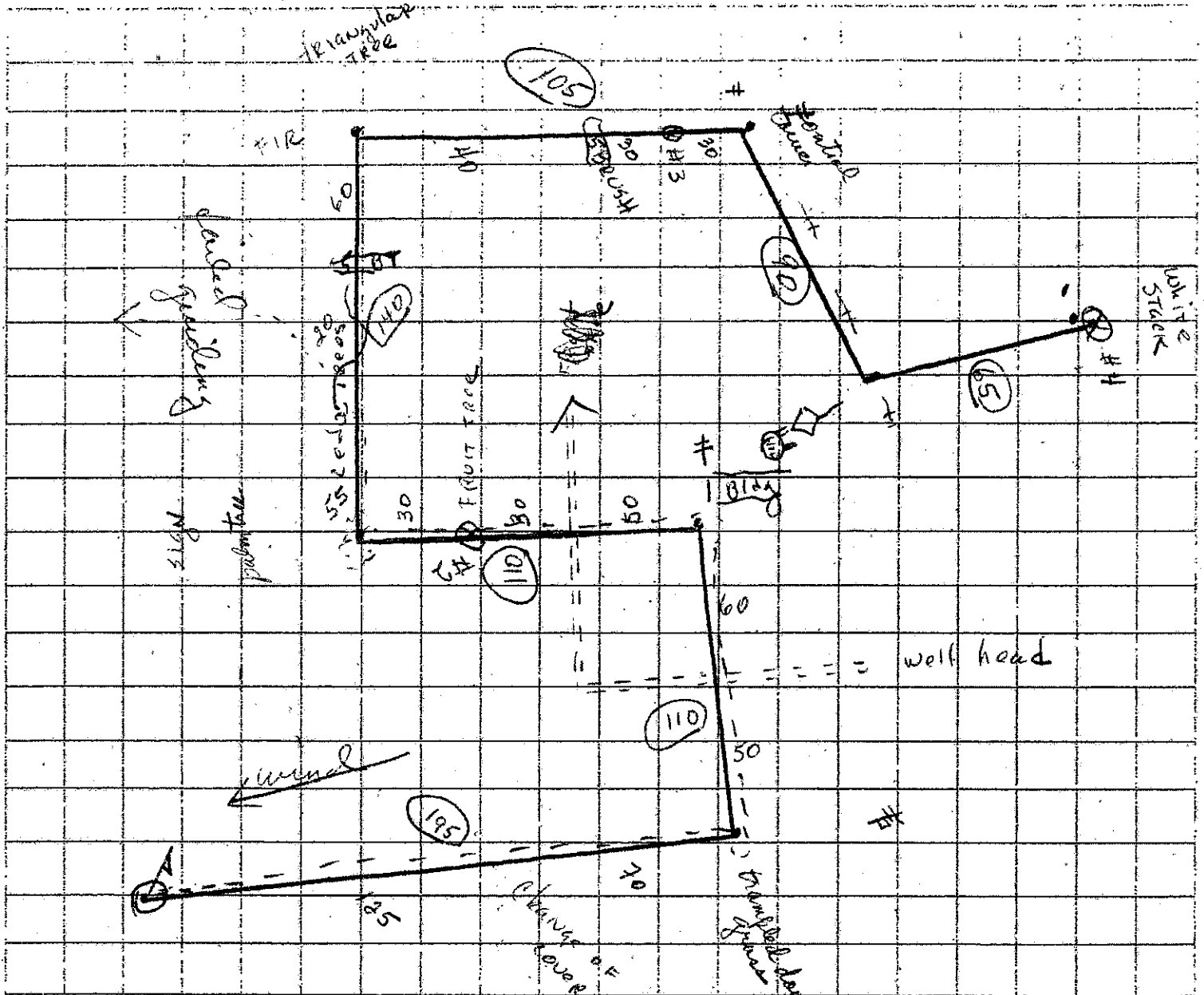

Passed or Failed Failed guiding  
(If failed state reason)

Tracklayer Started 7:30

X-Tracklayer Started 9:00

Dog's Starting Time 10:57

Dog's Finishing Time \_\_\_\_\_

Ground Conditions wet field grass

Weather Conditions sunny cool

Wind Speed slight breeze

If dog is absent, mark "absent" on the page.

I hereby certify that I have judged the above dog after having read the instructions on the cover of this book and followed them to the best of my ability.

Articles: 1. scarf 2. masonry block  
3. coin purse 4. glove

Obstacles/Surfaces: 1. change of cover 2. through cedar trees  
3. asphalt king 4. brush xing

Breed/Sex Newfoundland female

AKC Regis # WS4803120

Event # TRACS 2017584201

*[Signature]*  
Judge's Signature

DOG'S CATALOG # 105

TRACK # 3

TOTAL YDS 815

VEG.     

Chart the track, in solid line; the dog's course in broken line on graph below.

NON-VEG.     

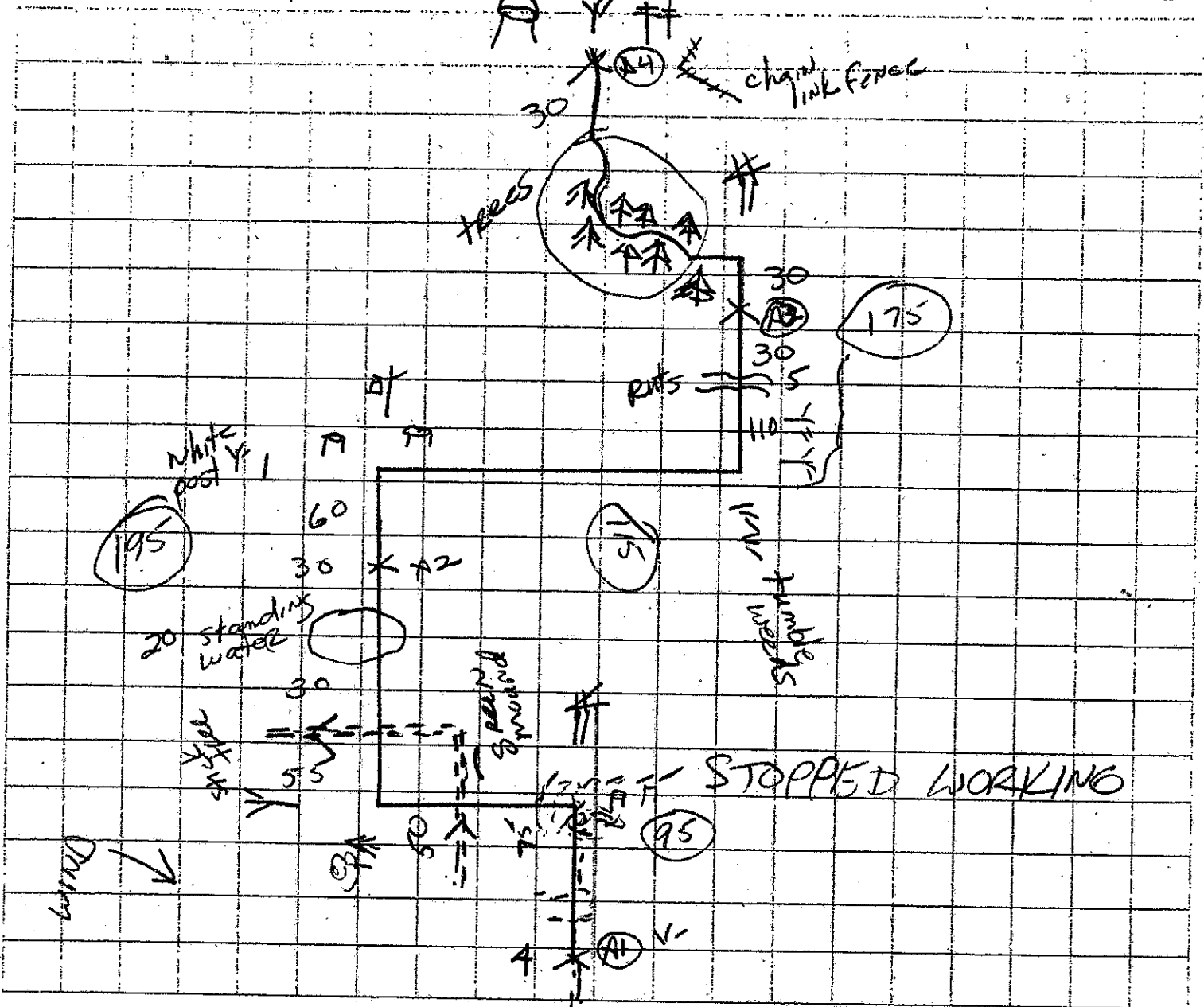

Passed or Failed (If failed state reason)

Stopped working

Tracklayer Started

8 AM

X-Tracklayer Started

9:30 A

Dog's Starting Time

11:28

Dog's Finishing Time

Ground Conditions

damp field grass

Weather Conditions

cool / sunny

Wind Speed

light breeze

If dog is absent, mark 'absent' on the page.

Articles:

1 scarf

2 sock

3 memory book

1 glove

Obstacles/  
Surfaces:

1 water

2 ruts

3 trees

Breed/Sex

Blood Hound / Female

AKC Regis #

HP43667304

Event #

2017584201

I hereby certify that I have judged the above dog after having read the instructions on the cover of this book and followed them to the best of my ability.

RL Crawford  
Judge's Signature

**DOG'S CATALOG #** Y105

**TRACK #** 3

**TOTAL YDS** 815

**VEG.** TDX

Chart the track in solid line; the dog's course in broken line on graph below.

**NON-VEG.** \_\_\_\_\_

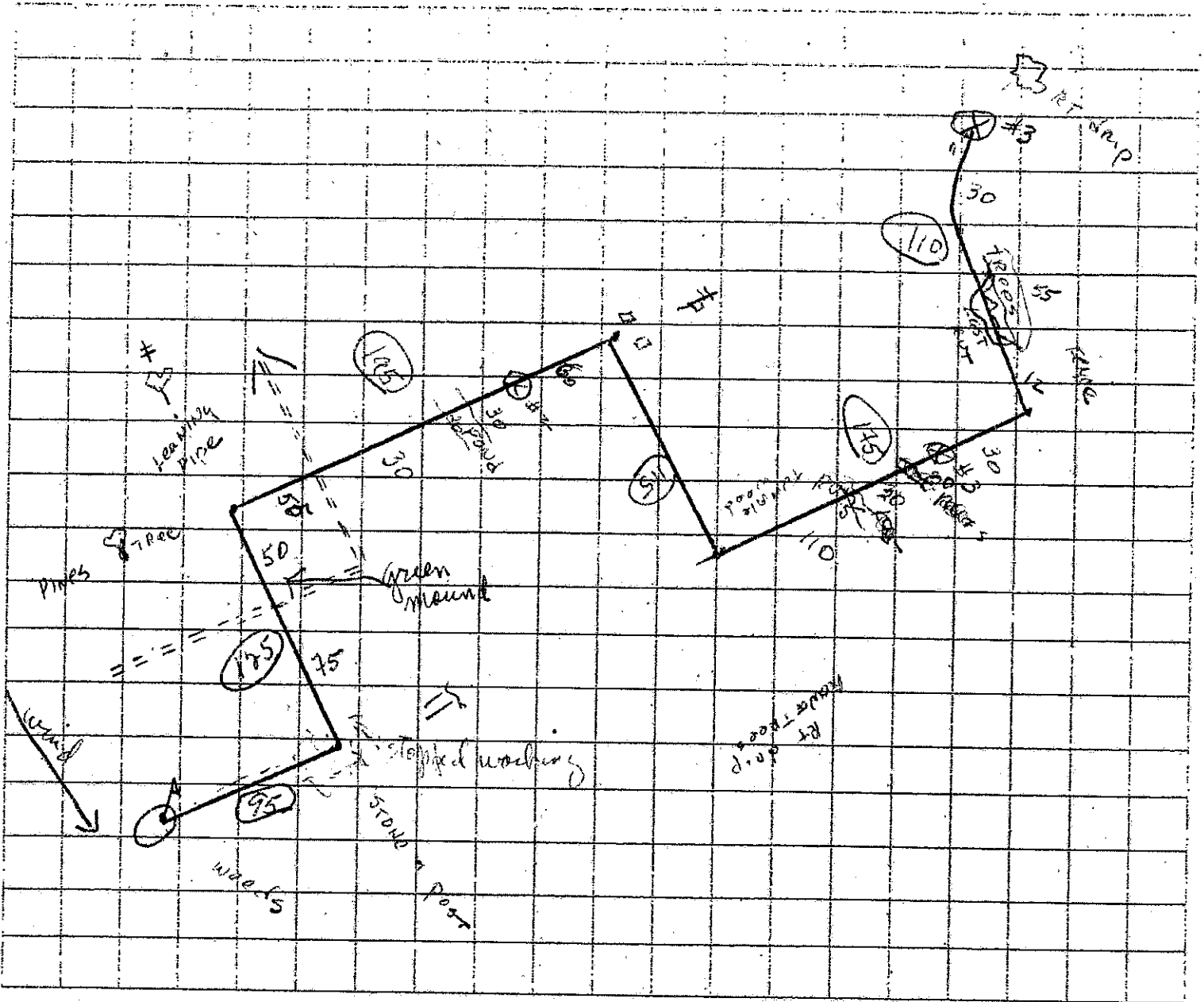

Passed or Failed failed stepped working  
 (If failed state reason)  
 Tracklayer Started 8:00  
 X-Tracklayer Started 9:30  
 Dog's Starting Time 11:28  
 Dog's Finishing Time \_\_\_\_\_  
 Ground Conditions damp field grass  
 Weather Conditions cool sunny  
 Wind Speed slight breeze

Articles: 1 scarf 2 sock  
3 memory hook 4 glove  
 Obstacles/  
 Surfaces: 1 powder king 2 going thru 7 Rees  
3 RVTS 4  
 Breed/Sex Bloodhound female  
 AKC Regis # HP43667304  
 Event # TRACS 2017584201

If dog is absent, mark "absent" on the page.

I hereby certify that I have judged the above dog after having read the instructions on the cover of this book and followed them to the best of my ability.

  
 Judge's Signature

DOG'S CATALOG # X106

TDX  
TRACK # AIT

TOTAL YDS 840

VEG.     

Chart the track in solid line; the dog's course in broken line on graph below.

NON-VEG.     

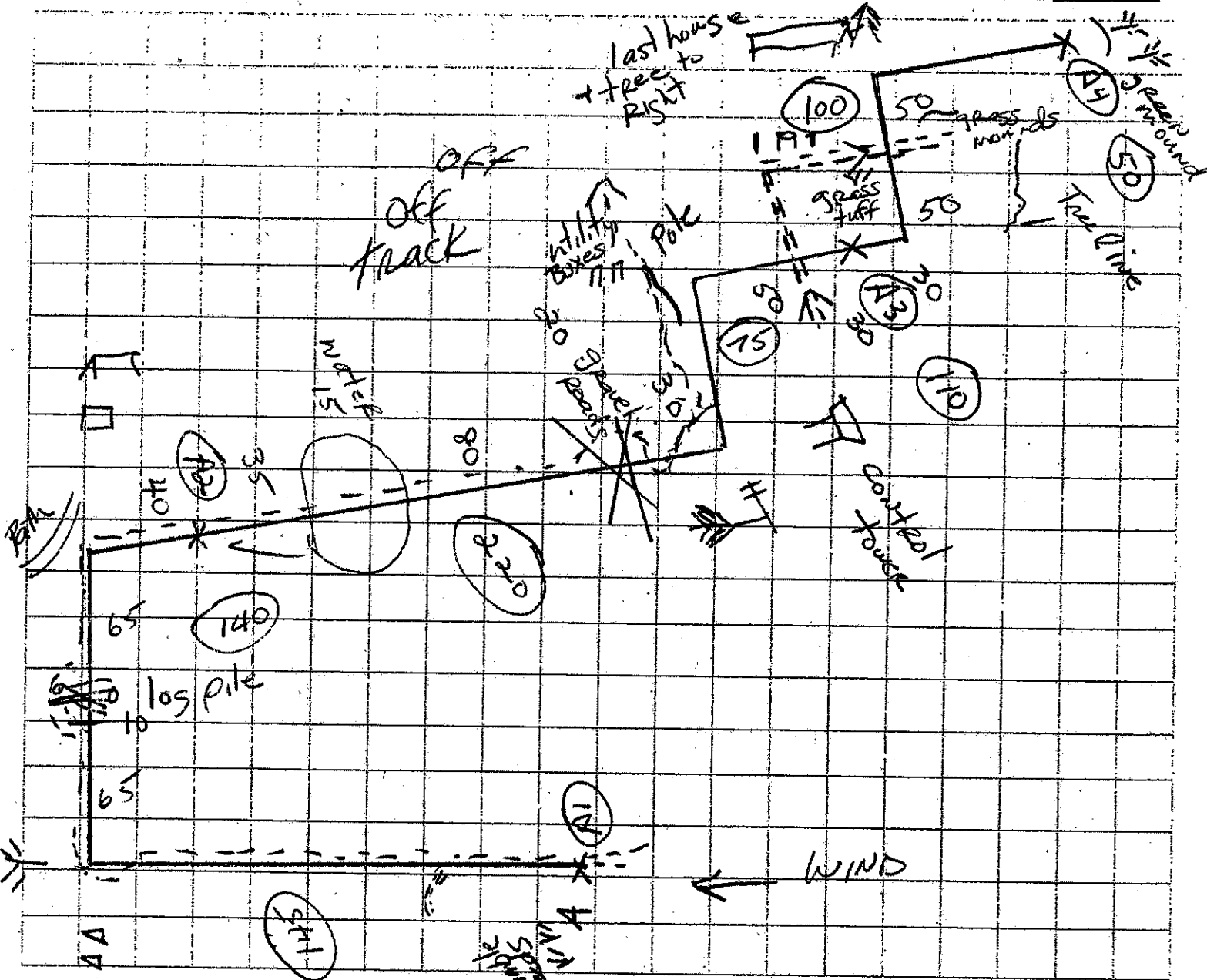

Passed or Failed OFF track

(If failed state reason)

Tracklayer Started 8:30 A

X-Tracklayer Started 10A

Dog's Starting Time 11:56 A

Dog's Finishing Time     

Ground Conditions greenfield grass

Weather Conditions overcast/cool

Wind Speed light breeze

If dog is absent, mark 'absent' on the page.

I hereby certify that I have judged the above dog after having read the instructions on the cover of this book and followed them to the best of my ability.

Articles:

1. scarf

2. memory book

3. coin puzzle

4. glove

Obstacles/  
Surfaces:

1. logs

2. water

3. gravel roads

Breed/Sex

Beagle/Male

AKC Regis #

2017584201

Event #

2017584201

RL Crawford  
Judge's Signature

DOG'S CATALOG # X106

TRACK # alt

TOTAL YDS 840

VEG. TDX  
NON-VEG. \_\_\_\_\_

Chart the track in solid line; the dog's course in broken line on graph below.

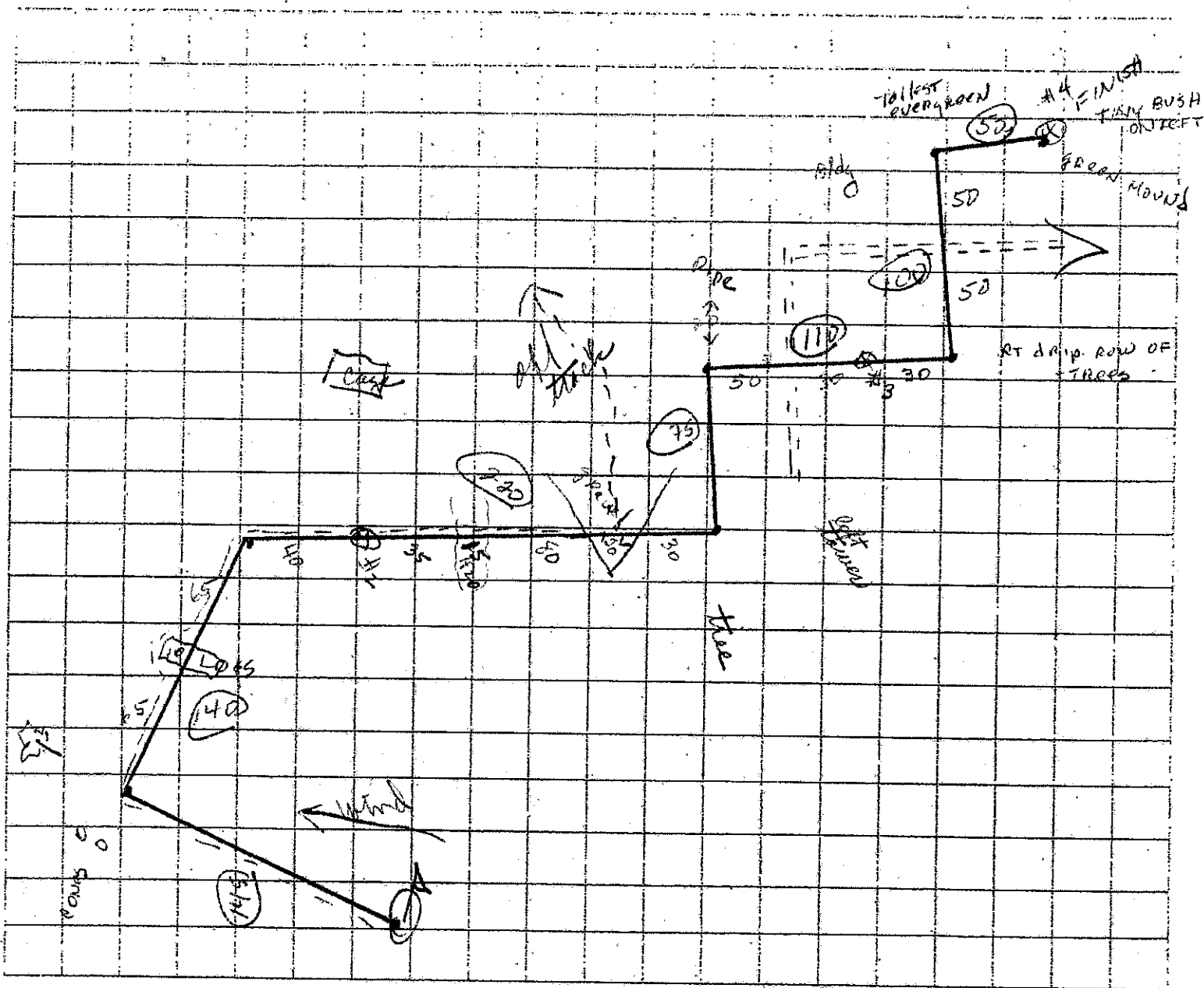

Passed or Failed Failed off track

(If failed state reason)

Tracklayer Started 8:30

X-Tracklayer Started 10:00

Dog's Starting Time 11:57

Dog's Finishing Time \_\_\_\_\_

Ground Conditions green field grass moist

Weather Conditions bazy cool

Wind Speed 3-5 mph

Articles:

- 1. scarf
- 2. memory book
- 3. rain shoes
- 4. glove

Obstacles/Surfaces:

- 1. log pile
- 2. water puddle
- 3. gravel pad
- 4. \_\_\_\_\_

Breed/Sex

Beagle male

AKC Regis #

HP43845401

Event #

TRACS 2017584201

If dog is absent, mark 'absent' on the page.

I hereby certify that I have judged the above dog after having read the instructions on the cover of this book and followed them to the best of my ability.

*[Handwritten Signature]*

Judge's Signature